

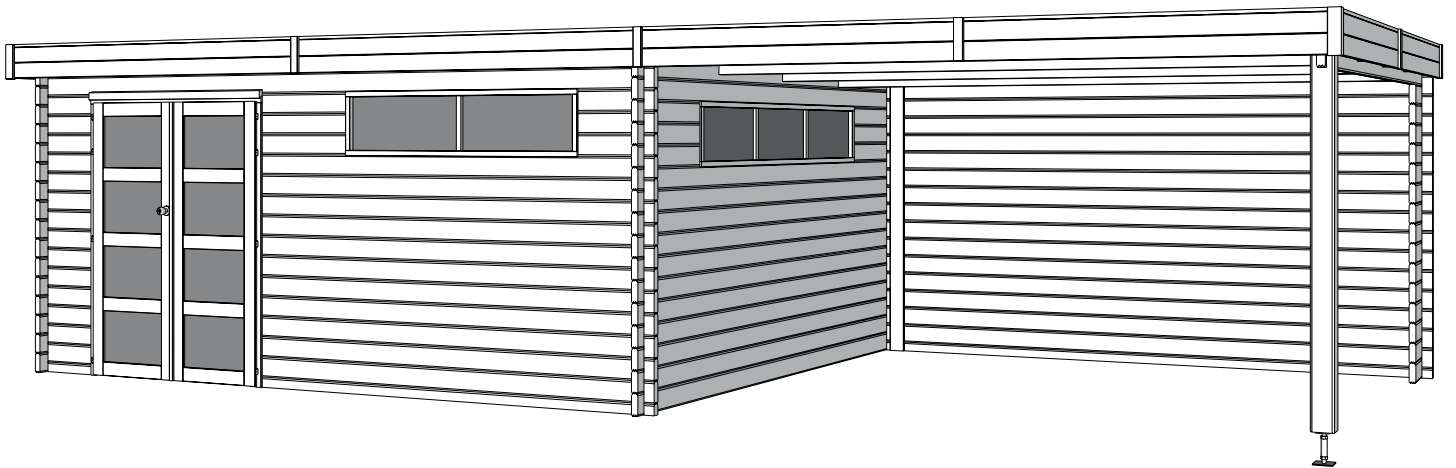

# **WOODLANDS**

## **QUALITY CABINS**



### **GEDETAILEERDE ONDERDELENLIJST**

-

### **LISTE D'INVENTAIRE DETAILLEE**

Download uw montage instructies op [www.gardenas.be](http://www.gardenas.be)

Téléchargez vos instructions de montage sur [www.gardenas.be](http://www.gardenas.be)

# Onderdelenlijst Liste d'inventaire

## Typ **44mm 505x385 cm PDDDM04**

### 4602AC/ISO

Artikel nr / Nr Article      Afmeting / Dimension      #      Functie / Fonction  
A      B      C

#### Wandelementen / Éléments des parois

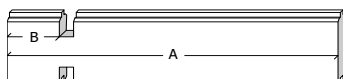

Z1/2950/0070	2950	70	(-)	<b>11</b>	onder raam voorgevel / sous fenêtre façade
Z1/0608/0070	608	70	(-)	<b>17</b>	naast deur en raam voorgevel / côté porte et fenêtre façade
Z1/0765/0070	765	70	(-)	<b>6</b>	naast raam zijgevel / côté fenêtre paroi latérale

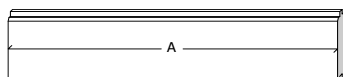

Z2/0607	607	(-)	(-)	<b>3</b>	tussen raam & deur voorgevel / entre fenêtre & porte façade
---------	-----	-----	-----	----------	---

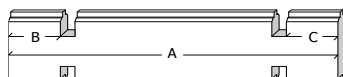

Z3/5050/0070/0070	5050	70	70	<b>16</b>	achter- & voorgevel / façade et paroi arrière
Z3/3850/0070/0070	3850	70	70	<b>27</b>	zijgevel / paroi latérale

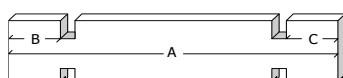

Z5/5050/0070/0070	5050	70	70	<b>1</b>	bovenste plank voorgevel / planche supérieure façade
-------------------	------	----	----	----------	--

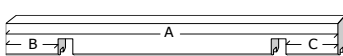

Z0/5050/QQ001	5050	70	70	<b>1</b>	bovenste plank achtergevel / planche supérieure paroi arrière
---------------	------	----	----	----------	---

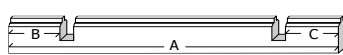

Z7/5050/0070/0070	5050	70	70	<b>2</b>	basis voor- & achtergevel / base paroi avant et arrière
-------------------	------	----	----	----------	---

#### Dakelementen / Éléments du toit



ZK/P2/3975/4/2/R	3975	195	70	<b>1</b>	helling rechts / pente droite
------------------	------	-----	----	----------	-------------------------------

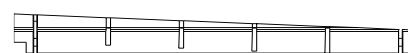

ZK/P2/3975/4/2/L	3975	195	70	<b>1</b>	helling links / pente gauche
------------------	------	-----	----	----------	------------------------------

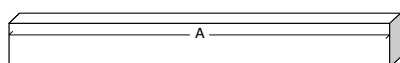

HDB/SET11				<b>1</b>	zak balkjes + sierlatjes / sachet poutres + lattes de finitions
P2/4880	4880	145	44	<b>4</b>	dakbalk / poutre du toit



PPD1AC/4050/1000	4050	1000	(-)	<b>5</b>	profielplaten / panneaux profilés
------------------	------	------	-----	----------	-----------------------------------

#### Afwerkingselementen / Éléments de finition

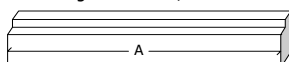

SRD/1522	1522	(-)	(-)	<b>2</b>	sierlat boven deurkader / latte de finition cadre de porte
----------	------	-----	-----	----------	--

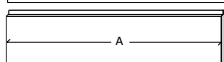

FSLMA/2540/115	2540	115	(-)	<b>2</b>	frontale sierlat tand / latte de finition frontale languette
FSLMB/2540/108	2540	108	(-)	<b>2</b>	frontale sierlat groef / latte de finition frontale rainure

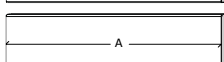

FSLMA/4080/115	4080	115	(-)	<b>2</b>	zij sierlat tand / latte de finition latérale languette
FSLMB/4080/108	4080	108	(-)	<b>2</b>	zij sierlat groef / latte de finition latérale rainure

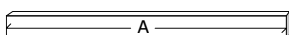

SSL45/2700	2700	(-)	(-)	<b>2</b>	stormsierlat op het dak (voorkant) / latte de finition sur le toit (façade)
SSL45/4200	4200	(-)	(-)	<b>2</b>	stormsierlat op het dak (zijkant) / latte de finition sur le toit (latérale)
M/1920	1920	(-)	(-)	<b>1</b>	makelaar deur / latte de cache porte

DDM04-S/PLXM				<b>1</b>	opdeur modern voor slot / porte modern à recouvrement serrure
DDM04-V/PLXM				<b>1</b>	opdeur modern vast / porte modern à recouvrement fixe
X/DDO	(3 delen / 3 pièces)			<b>1</b>	kader 44mm voor dubbele opdeur / cadre 44mm pour porte double à recouvrement

X/VRM2L/PLXM				<b>1</b>	vast raam 2 delig / fenêtre fixe 2 parties
--------------	--	--	--	----------	--

X/VRM3K/PLXM				<b>1</b>	vast raam 3 delig / fenêtre fixe 3 parties
--------------	--	--	--	----------	--

B/4602AC				<b>1</b>	zak beslag / sachet quincaillerie
----------	--	--	--	----------	-----------------------------------

# Onderdelenlijst Liste d'inventaire

## Typ 44mm 400x385 cm EXTPD

### 4600AB4040

Artikel nr / Nr Article      Afmeting / Dimension      #      Functie / Fonction  
A      B      C

#### Wandelementen / Éléments des parois

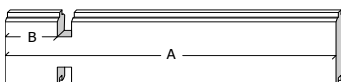

Z1/0425/0070      425      70      (-)      **15**      zijgevel extensie / paroi latéral extension  
Z1/3955/0070      3955      70      (-)      **15**      achtergevel extensie / paroi arrière extension

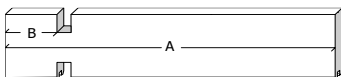

Z5/4070/0070      4070      70      (-)      **1**      bovenste plank voorgevel extensie / planche supérieure façade extension

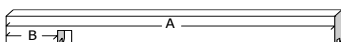

Z0/4070/0070      4070      70      (-)      **1**      bovenste plank achtergevel ext / planche supérieure paroi arrière ext

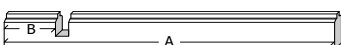

Z7/3955/0070      3955      70      (-)      **1**      basis achtergevel extensie / base paroi arrière extension

#### Dakelementen / Éléments du toit



ZK/P2/3975      3975      195      70      **1**      helling / pente

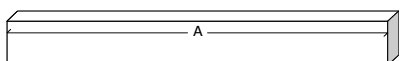

599937      1909      (-)      (-)      **1**      paal / poteau  
HDB/SET9                          **1**      zak balkjes + sierlatjes / sachet poutres + lattes de finitions  
P2/3956      3956      145      44      **3**      dakbalk / poutre du toit



300035      290      120      120      **1**      U-anker / U-socle



PPD1AC/4050/1000      4050      1000      (-)      **4**      profielplaten / panneaux profilés

#### Afwerkingselementen / Éléments de finition

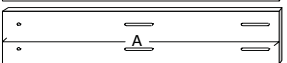
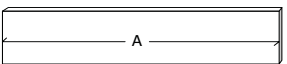
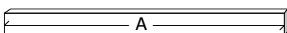
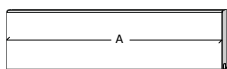
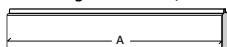

FSLMA/4080/115      4080      115      (-)      **1**      frontale sierlat tand / latte de finition frontale languette  
FSLMB/4080/108      4080      108      (-)      **1**      frontale sierlat groef / latte de finition frontale rainure  
**te zagen op lengte 4000 mm / à scier sur longueur 4000 mm**

S/045/045/2010      2010      45      45      **1**      balkje verbinding achterwand / poutrelle connection par. arrière  
SSL45/4200      4200      (-)      (-)      **1**      stormsierlat op het dak (voorkant) / latte de finition sur le toit (façade)

FSL/2100      2100      (-)      (-)      **1**      sierlat verbinding achterwand / latte de finition connection par. arrière

599906      2100      (-)      (-)      **1**      sierlat verbinding achterwand / latte de finition connection par. arrière

B/4600AB                          **1**      zak beslag / sachet quincaillerie

# 44MM 505X385 CM (ART 4602AC/ISO)

## VOORZIJDDE - FACADE

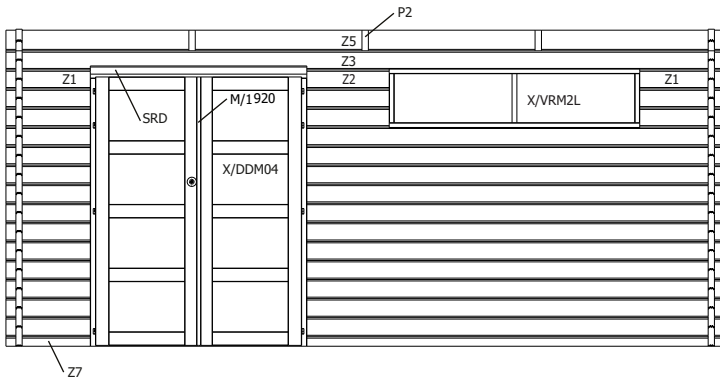

## RUGZIJDDE - PAROI ARRIERE

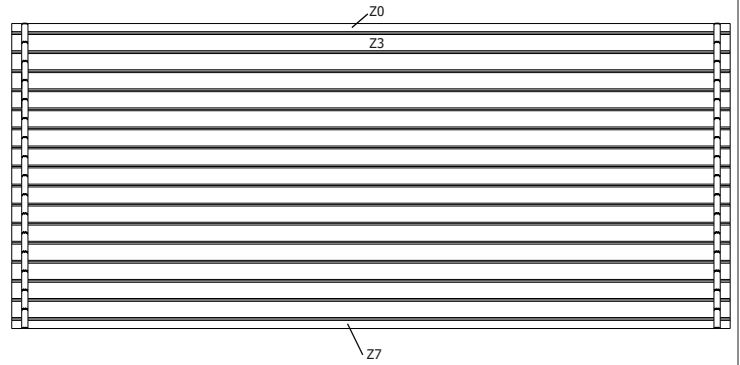

## ZIJWAND - PAROI LATERALE

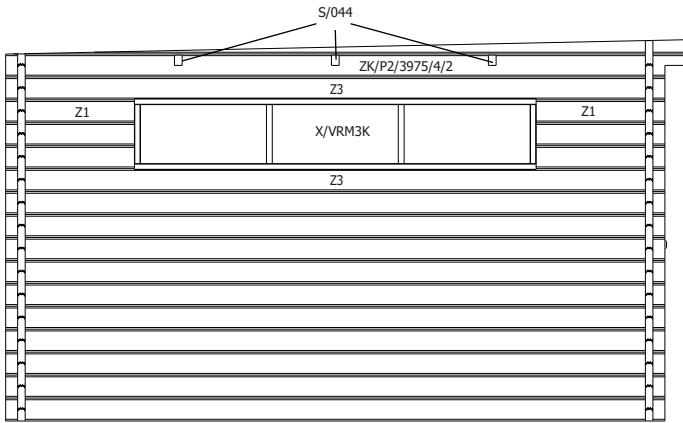

## ZIJWAND - PAROI LATERALE

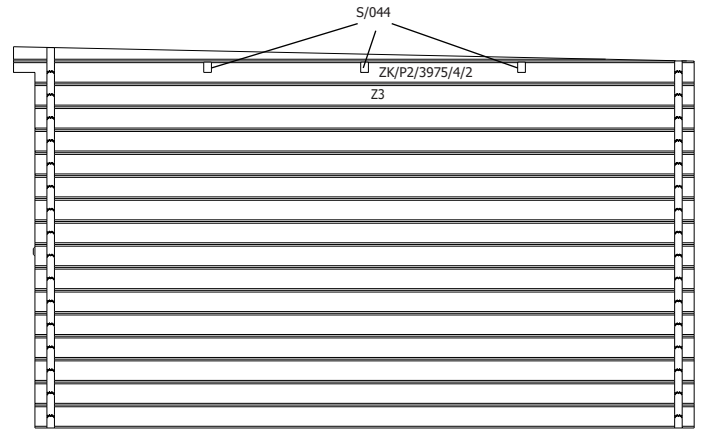

## DAK - TOITURE

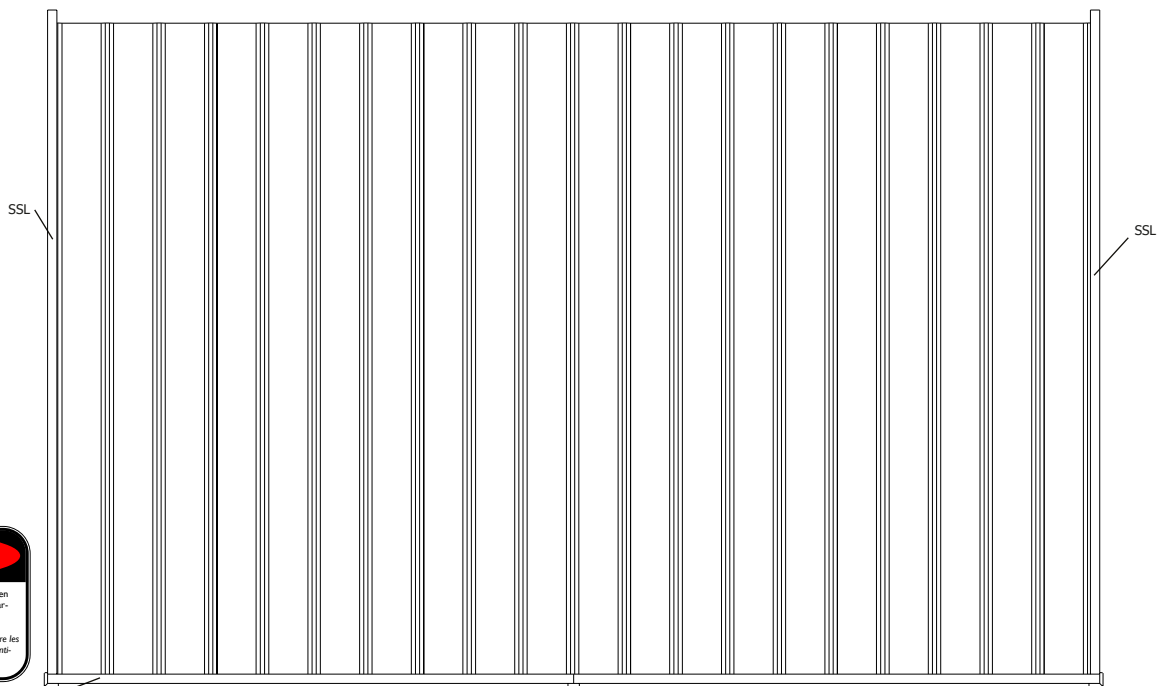

plaatsing van de staalplaten (vooraanzicht)

pose du toit en tôle (vue de face)

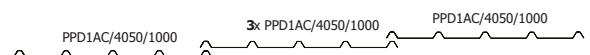

# 44MM 400X385 CM EXTPD (ART 4600AB4040AC/ISO)

## ZIJAANZICHT - VUE LATERALE

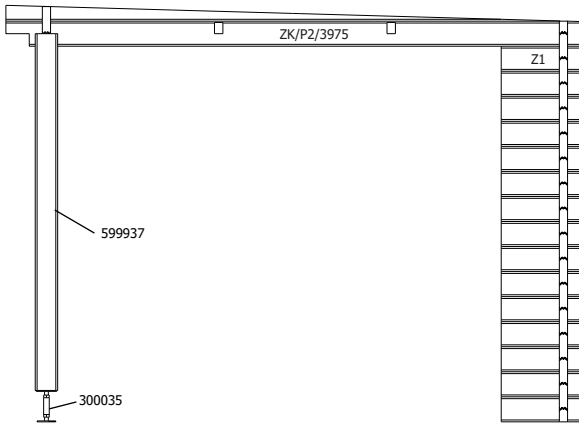

## VOORZIJDJE - FACADE

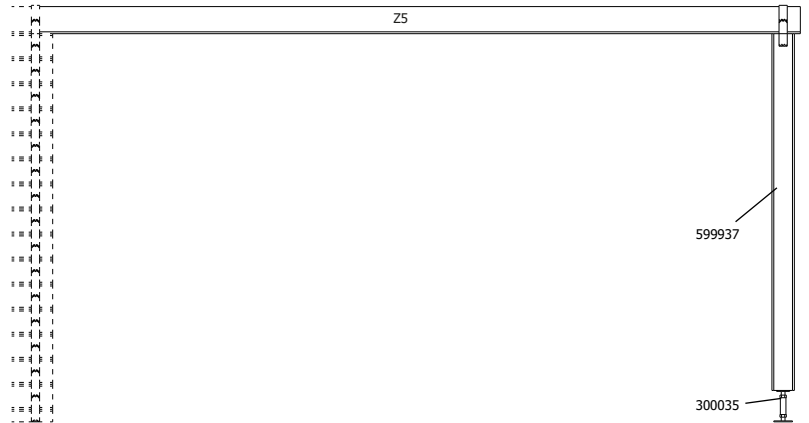

## ACHTERZIJDJE - VUE ARRIERE

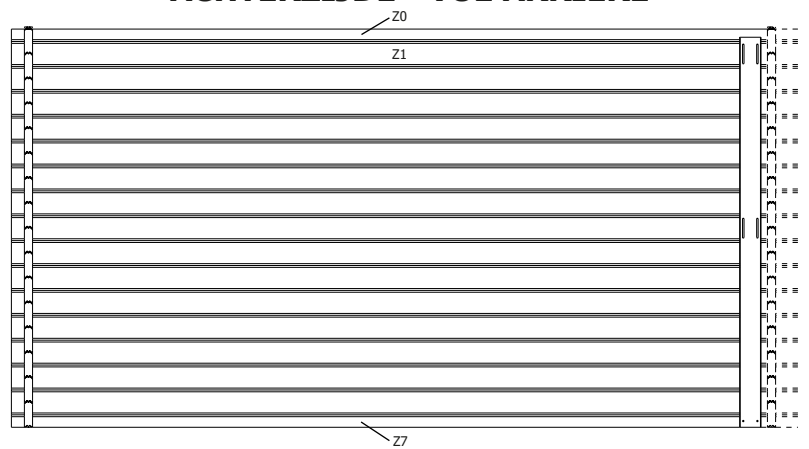

DANGER

Beveilig uw aankoop tegen stormweer! Koop de Gardenas stormbeveiliging.

Sécurisez votre achat contre les tempêtes! Achetez le kit anti-tempête Gardenas.

## DAK - TOITURE

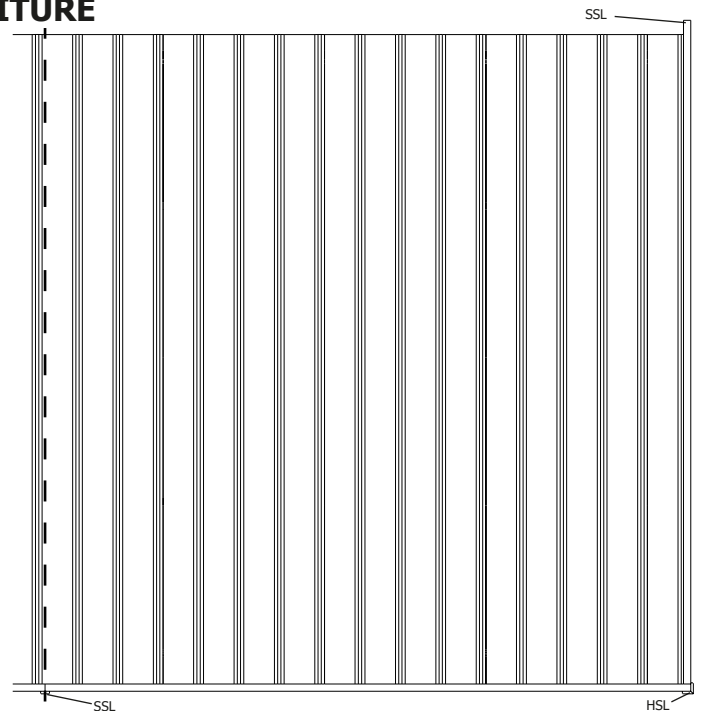
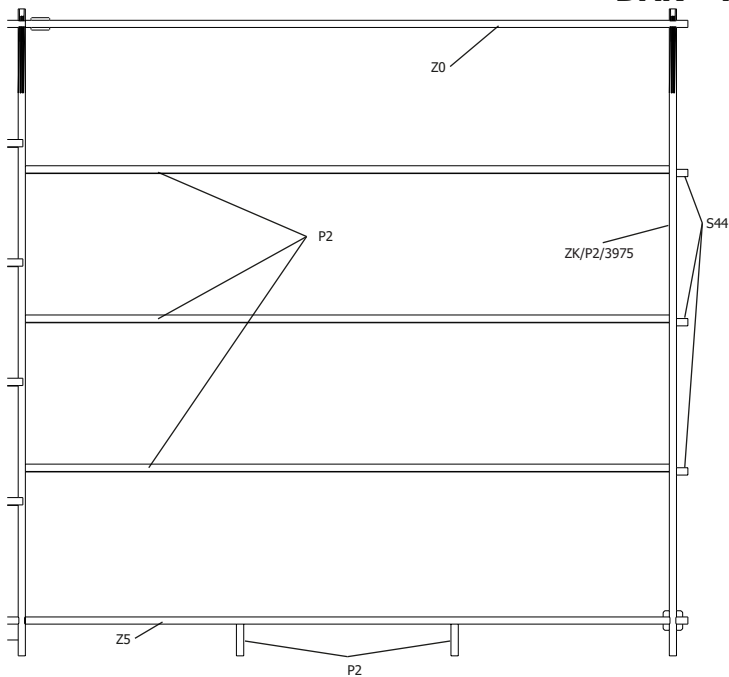

plaatsing van de staalplaten (vooraanzicht) - pose du toit en tôle (vue de face)

REF 4602EXT

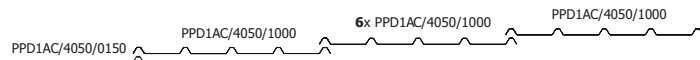
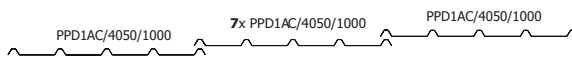

REF 4604EXT

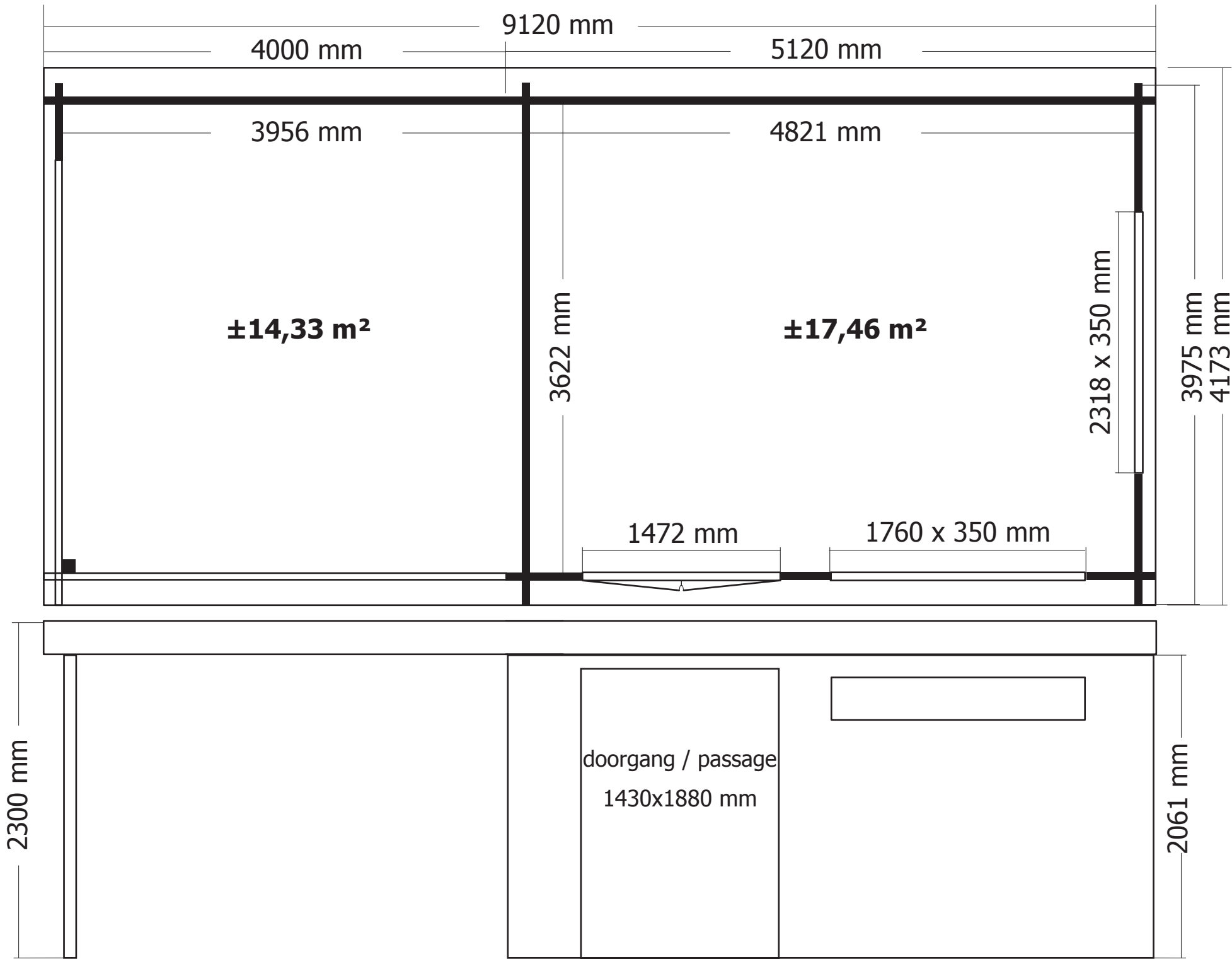

## B/4602AC

aantal / nombre

Slot - Serrure (knoblock 28-45mm)  
(Ref = 333005)

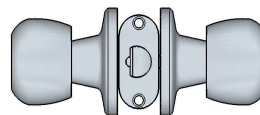

1

Scharnier paumelle groot - Charnière paumelle grand  
(Ref = 300014)

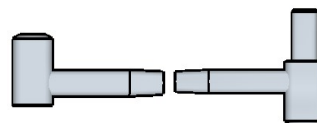

8 set

Kantschuif - Pêne (120mm)  
(Ref = 300019)



2

Hoekijzer groot - Equerre grand (60x60x40)  
(Ref = 300024)

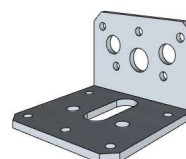

2

### Schroeven - Vis

25mm  
(Ref = 310018)



33

35mm  
(Ref = 310007)



30

50mm  
(Ref = 310013)



30

70mm  
(Ref = 310009)



22

100mm  
(Ref = 310005)



14

Schroef + kapje - Vis + capuchon (100mm)  
(Ref = 310005 & 399007)

110

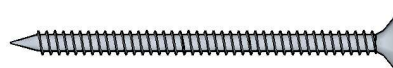

## B/4600AB

Rondel - Rondelle (M8)  
(Ref = 330001)

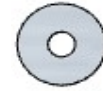

aantal / nombre

10

Houtdraadbout - Boulon (8x40)  
(Ref = 340002)



10

### Schroeven - Vis

25mm  
(Ref = 310018)

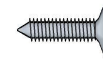

10

35mm  
(Ref = 310007)



20

50mm  
(Ref = 310013)



16

70mm  
(Ref = 310009)



8

100mm  
(Ref = 310005)



28

Schroef + kapje - Vis + capuchon (100mm)  
(Ref = 310005 & 399007)

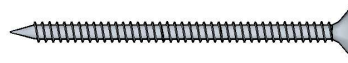

65



# HDB/SET11

Voor artikel / Pour article:

4602

4604

4612AC

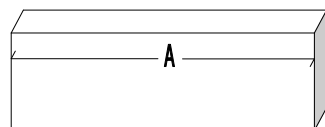

ARTIKEL NR  
NR ARTICLE

P2/0195

S/044/060/0070

AANTAL  
NOMBRE

3

6

FUNCTIE  
FONCTION

hulpdakbalk / poutre de toit d'aide

hulpdakbalk / poutre de toit d'aide



SSL/0230

HSL/0230

7

4

sierlat / latte de finition

sierlat hoek / latte de finition coin

# HDB/SET9

**Voor artikel / Pour article:**

4600AB4030

4600AB4040

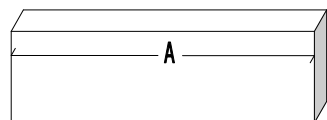

<u>ARTIKEL NR</u>	<u>AANTAL</u>	<u>FUNCTIE</u>
<u>NR ARTICLE</u>	<u>NOMBRE</u>	<u>FONCTION</u>
P2/0195	2	hulpdakbalk / poutre de toit d'aide

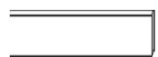

SSL/0230	2	sierlat / latte de finition
----------	---	-----------------------------