

44MM 415+400X385 CM (ART 4604EXT400AC/ISO)

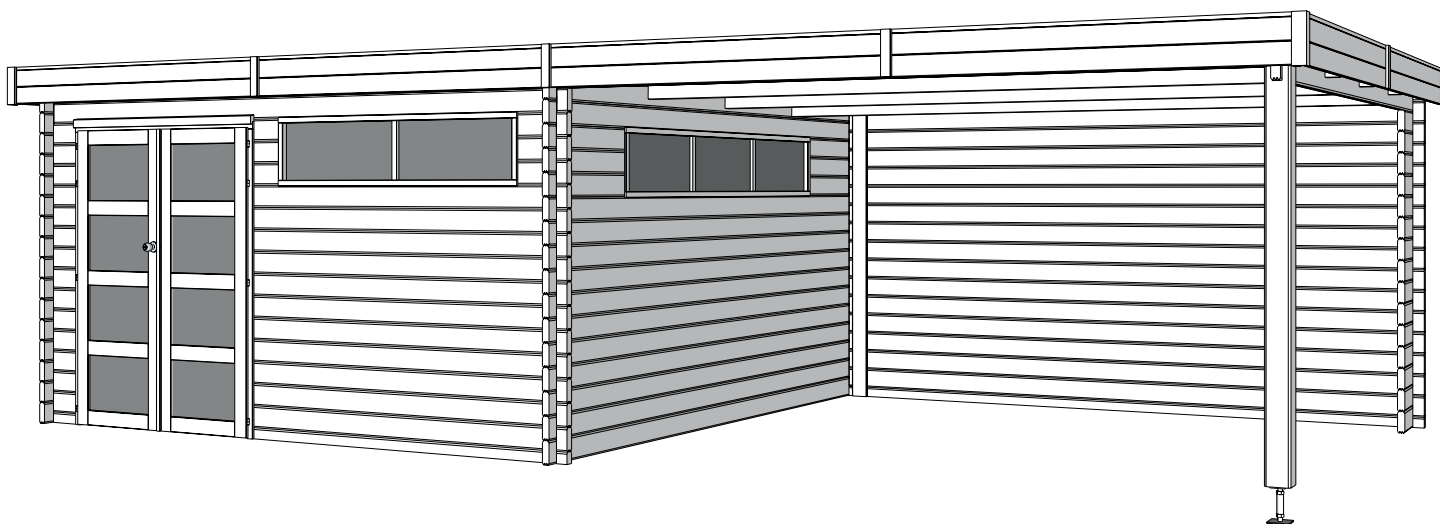

WOODLANDS

QUALITY CABINS



GEDETAILEERDE ONDERDELENLIJST

-

LISTE D'INVENTAIRE DETAILLEE

Download uw montage instructies op www.gardenas.be

Téléchargez vos instructions de montage sur www.gardenas.be

Onderdelenlijst Liste d'inventaire

Typ **44mm 415x385 cm PDDDM04**

4604AC/ISO

Artikel nr / Dimension # Functie / Fonction
Nr Article A B C

Wandelementen / Éléments des parois

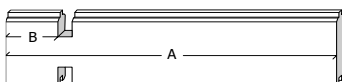

Z1/2313/0070	2313	70	(-)	11	onder raam voorgevel / sous fenêtre façade
Z1/0345/0070	345	70	(-)	17	naast deur en raam voorgevel / côté porte et fenêtre façade
Z1/0765/0070	765	70	(-)	6	naast raam zijgevel / côté fenêtre paroi latérale

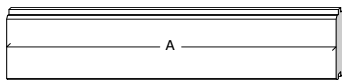

Z2/0233	233	(-)	(-)	3	tussen raam & deur voorgevel / entre fenêtre & porte façade
---------	-----	-----	-----	----------	---

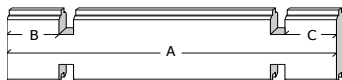

Z3/4150/0070/0070	4150	70	70	16	achter- & voorgevel / façade et paroi arrière
Z3/3850/0070/0070	3850	70	70	27	zijgevel / paroi latérale

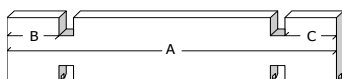

Z5/4150/0070/0070	4150	70	70	1	bovenste plank voorgevel / planche supérieure façade
-------------------	------	----	----	----------	--

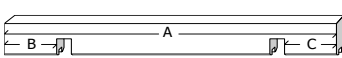

Z0/4150/QQ001	4150	70	70	1	bovenste plank achtergevel / planche supérieure paroi arrière
---------------	------	----	----	----------	---

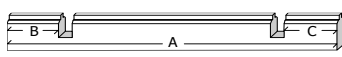

Z7/4150/0070/0070	4150	70	70	2	basis voor- & achtergevel / base paroi avant et arrière
-------------------	------	----	----	----------	---

Dakelementen / Éléments du toit



ZK/P2/3975/4/2/R	3975	195	70	1	helling rechts / pente droite
------------------	------	-----	----	----------	-------------------------------



ZK/P2/3975/4/2/L	3975	195	70	1	helling links / pente gauche
------------------	------	-----	----	----------	------------------------------

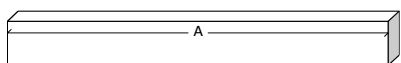

HDB/SET11				1	zak balkjes + sierlatjes / sachet poutres + lattes de finitions
P2/3980	3980	145	44	4	dakbalk / poutre du toit

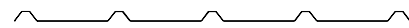

PPD1AC/4050/1000	4050	1000	(-)	4	profielplaten / panneaux profilés
------------------	------	------	-----	----------	-----------------------------------



PPD1AC/4050/0150	4050	150	(-)	1	profielplaten / panneaux profilés
------------------	------	-----	-----	----------	-----------------------------------

Afwerkingselementen / Éléments de finition

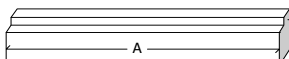

SRD/1522	1522	(-)	(-)	2	sierlat boven deurkader / latte de finition cadre de porte
----------	------	-----	-----	----------	--

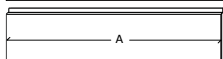

FSLMA/2090/115	2090	115	(-)	2	frontale sierlat tand / latte de finition frontale languette
FSLMB/2090/108	2090	108	(-)	2	frontale sierlat groef / latte de finition frontale rainure

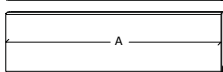

FSLMA/4080/115	4080	115	(-)	2	zij sierlat tand / latte de finition latérale languette
FSLMB/4080/108	4080	108	(-)	2	zij sierlat groef / latte de finition latérale rainure

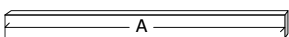

SSL45/4200	4200	(-)	(-)	1	stormsierlat op het dak (voorkant) / latte de finition sur le toit (façade)
SSL45/4200	4200	(-)	(-)	2	stormsierlat op het dak (zijkant) / latte de finition sur le toit (latérale)
M/1920	1920	(-)	(-)	1	makelaar deur / latte de cache porte

DDM04-S/PLXM				1	opdekdeur modern voor slot / porte modern à recouvrement serrure
DDM04-V/PLXM				1	opdekdeur modern vast / porte modern à recouvrement fixe
X/DDO	(3 delen / 3 pièces)			1	kader 44mm voor dubbele opdekdeur / cadre 44mm pour porte double à recouvrement

X/VRM2L/PLXM				1	vast raam 2 delig / fenêtre fixe 2 parties
--------------	--	--	--	----------	--

X/VRM3K/PLXM				1	vast raam 3 delig / fenêtre fixe 3 parties
--------------	--	--	--	----------	--

B/4604AC				1	zak beslag / sachet quincaillerie
----------	--	--	--	----------	-----------------------------------

Onderdelenlijst Liste d'inventaire

Typ 44mm 400x385 cm EXTPD

4600AB4040

Artikel nr / Nr Article Afmeting / Dimension # Functie / Fonction
A B C

Wandelementen / Éléments des parois

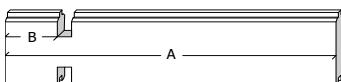

Z1/0425/0070 425 70 (-) **15** zijgevel extensie / paroi latéral extension
Z1/3955/0070 3955 70 (-) **15** achtergevel extensie / paroi arrière extension

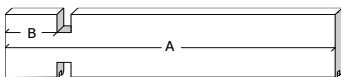

Z5/4070/0070 4070 70 (-) **1** bovenste plank voorgevel extensie / planche supérieure façade extension

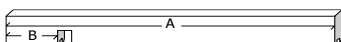

Z0/4070/0070 4070 70 (-) **1** bovenste plank achtergevel ext / planche supérieure paroi arrière ext

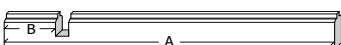

Z7/3955/0070 3955 70 (-) **1** basis achtergevel extensie / base paroi arrière extension

Dakelementen / Éléments du toit



ZK/P2/3975 3975 195 70 **1** helling / pente

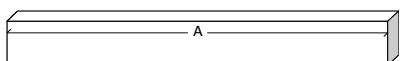

599937 1909 (-) (-) **1** paal / poteau
HDB/SET9 **1** zak balkjes + sierlatjes / sachet poutres + lattes de finitions
P2/3956 3956 145 44 **3** dakbalk / poutre du toit



300035 290 120 120 **1** U-anker / U-socle



PPD1AC/4050/1000 4050 1000 (-) **4** profielplaten / panneaux profilés

Afwerkingselementen / Éléments de finition

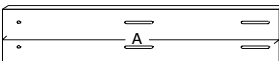
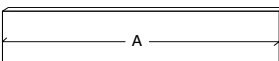
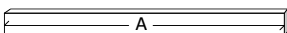
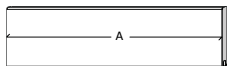
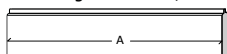

FSLMA/4080/115 4080 115 (-) **1** frontale sierlat tand / latte de finition frontale languette
FSLMB/4080/108 4080 108 (-) **1** frontale sierlat groef / latte de finition frontale rainure
te zagen op lengte 4000 mm / à scier sur longueur 4000 mm

S/045/045/2010 2010 45 45 **1** balkje verbinding achterwand / poutrelle connection par. arrière
SSL45/4200 4200 (-) (-) **1** stormsierlat op het dak (voorkant) / latte de finition sur le toit (façade)

FSL/2100 2100 (-) (-) **1** sierlat verbinding achterwand / latte de finition connection par. arrière

599906 2100 (-) (-) **1** sierlat verbinding achterwand / latte de finition connection par. arrière

B/4600AB **1** zak beslag / sachet quincaillerie

44MM 415X385 CM (ART 4604AC/ISO)

VOORZIJDDE - FACADE

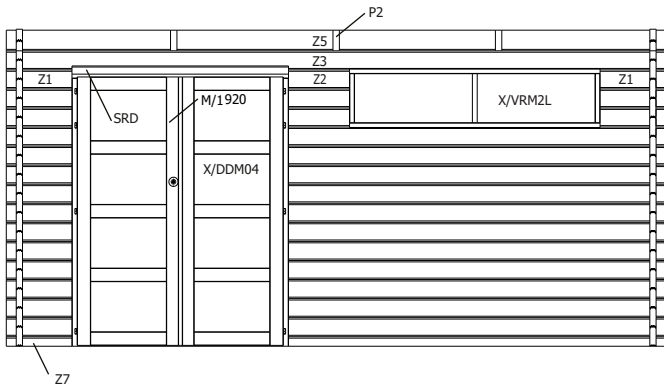

RUGZIJDDE - PAROI ARRIERE

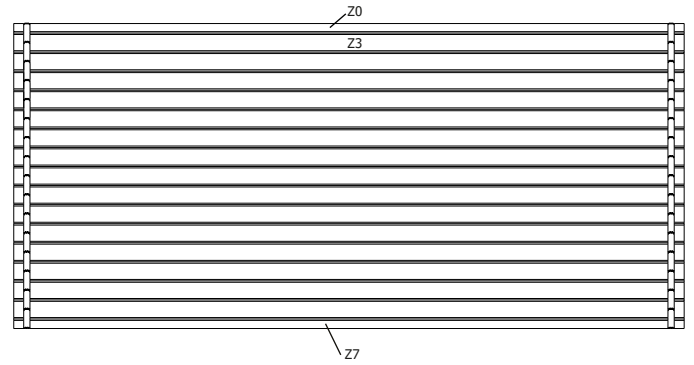

ZIJWAND - PAROI LATERALE

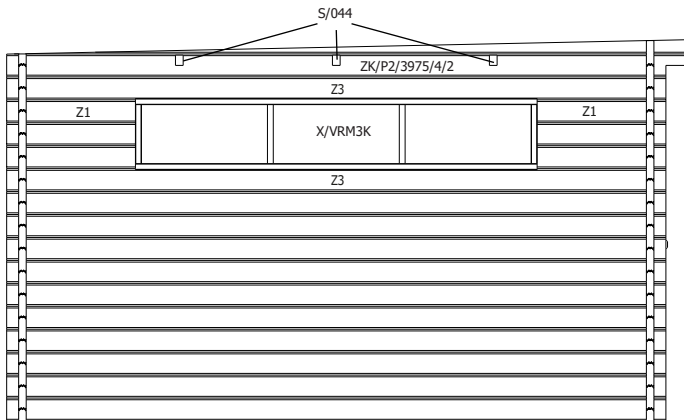

ZIJWAND - PAROI LATERALE

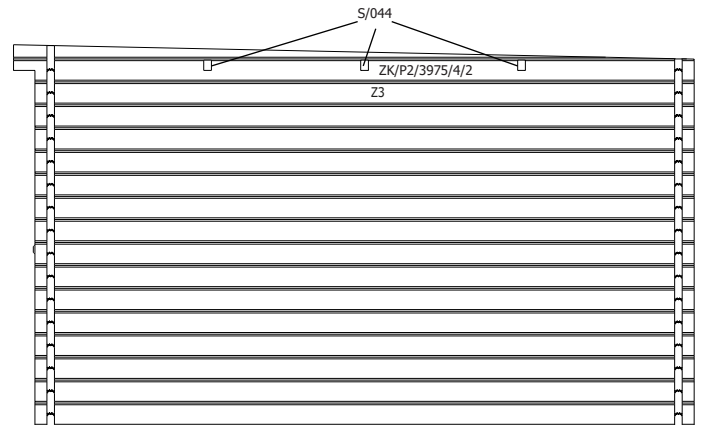

DAK - TOITURE

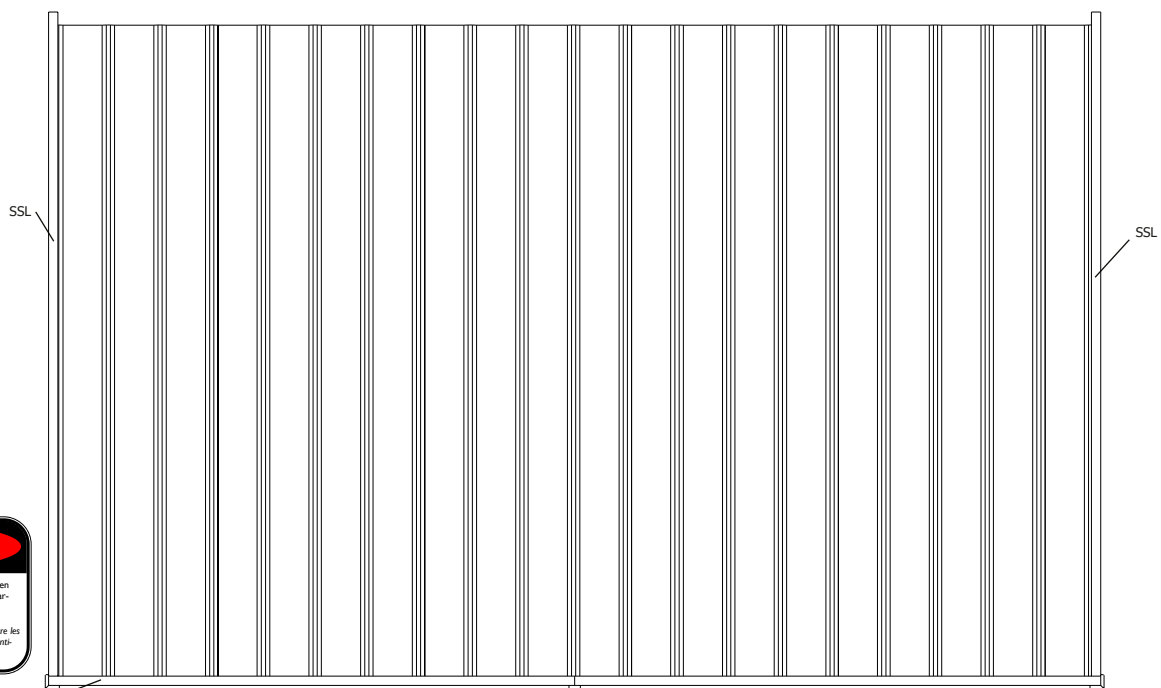

plaatsing van de staalplaten (vooraanzicht)

pose du toit en tôle (vue de face)

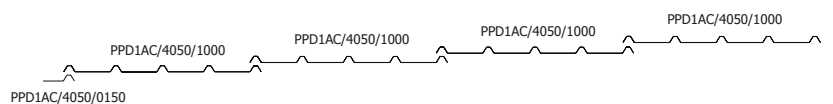

44MM 400X385 CM EXTPD (ART 4600AB4040AC/ISO)

ZIJAANZICHT - VUE LATERALE

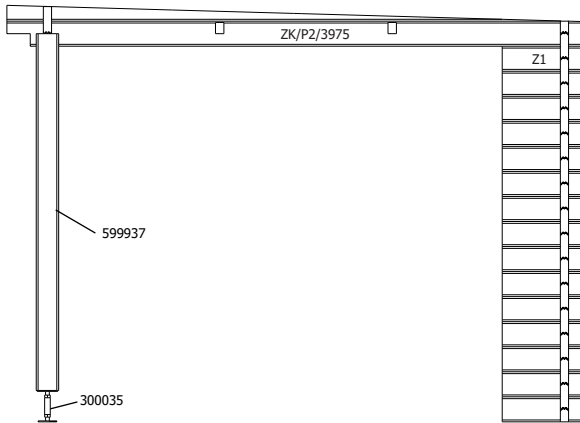

VOORZIJDJE - FACADE



ACHTERZIJDJE - VUE ARRIERE

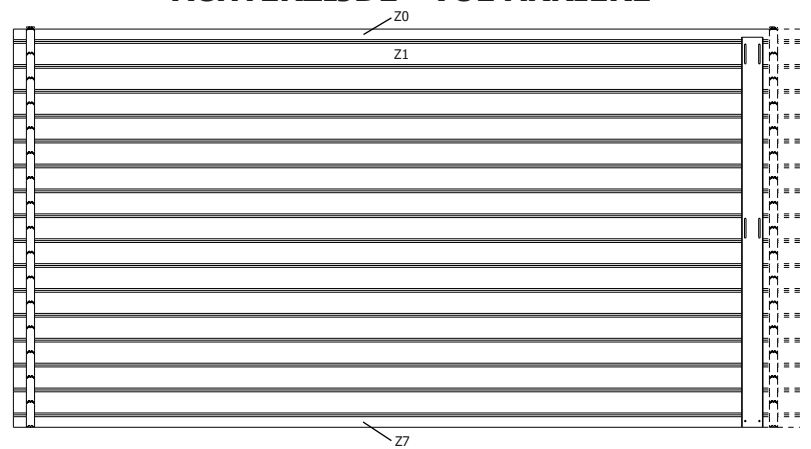

DANGER



Beveilig uw aankoop tegen stormweer! Koop de Gardenas stormbeveiliging.

Sécurisez votre achat contre les tempêtes! Achetez le kit anti-tempête Gardenas.

DAK - TOITURE

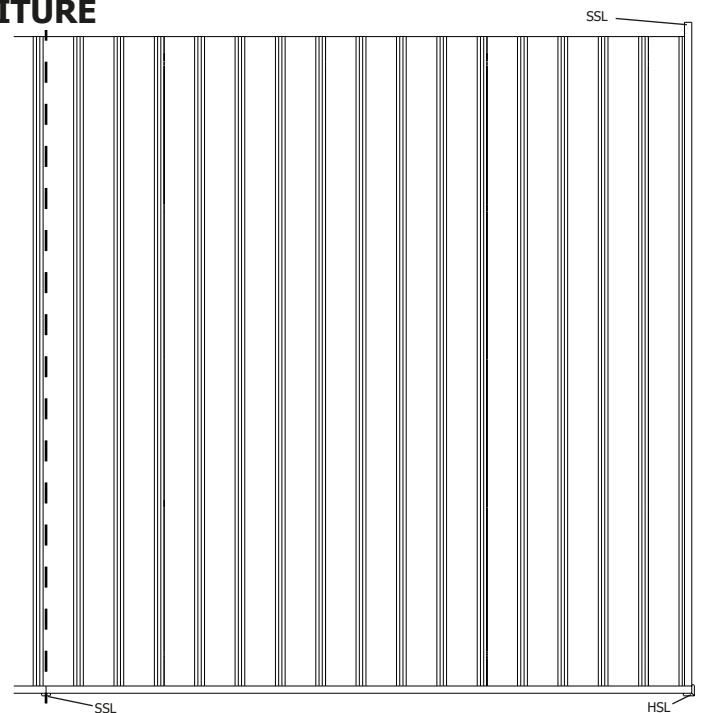
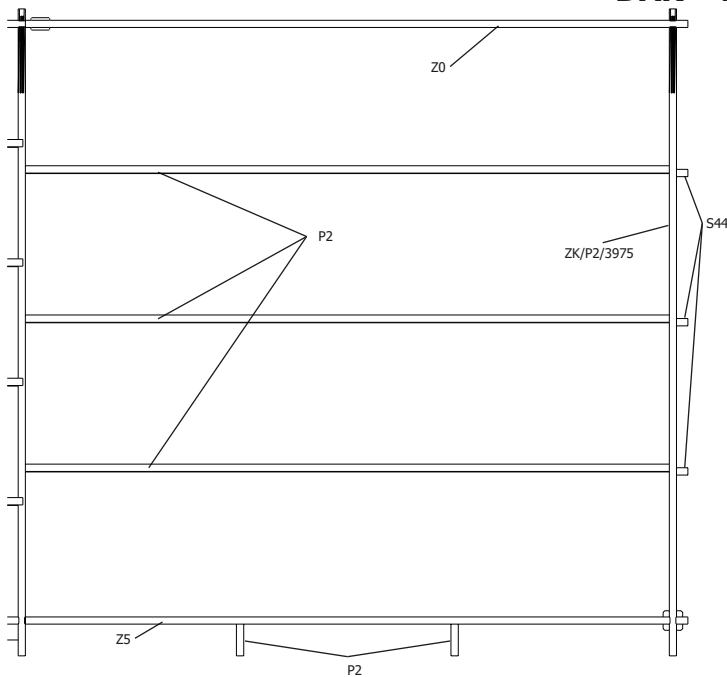

plaatsing van de staalplaten (vooraanzicht) - pose du toit en tôle (vue de face)

REF 4602EXT

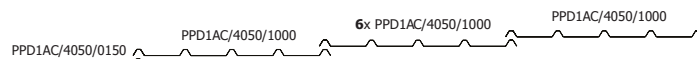
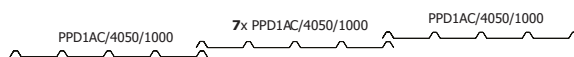

REF 4604EXT

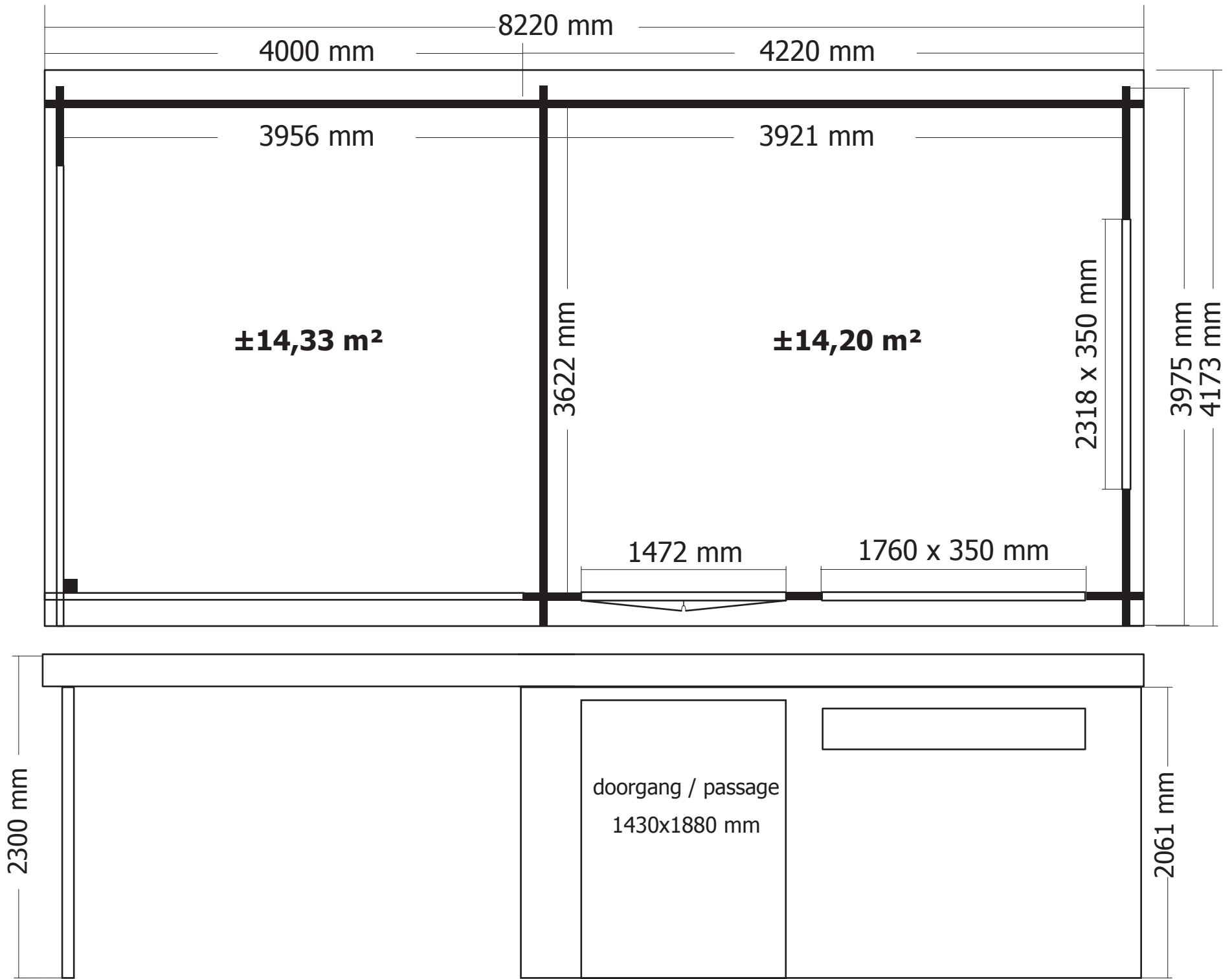

B/4604AC

aantal / nombre

Slot - Serrure (knoblock 28-45mm)
(Ref = 333005)

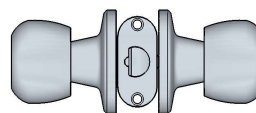

1

Scharnier paumelle groot - Charnière paumelle grand
(Ref = 300014)

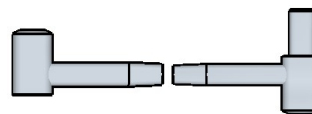

8 set

Kantschuif - Pêne (120mm)
(Ref = 300019)



2

Hoekijzer groot - Equerre grand (60x60x40)
(Ref = 300024)

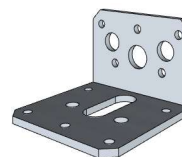

2

Schroeven - Vis

25mm
(Ref = 310018)



33

35mm
(Ref = 310007)



26

50mm
(Ref = 310013)



30

70mm
(Ref = 310009)



22

100mm
(Ref = 310005)



14

Schroef + kapje - Vis + capuchon (100mm)
(Ref = 310005 & 399007)

94



B/4600AB

Rondel - Rondelle (M8)
(Ref = 330001)

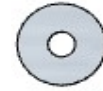

aantal / nombre

10

Houtdraadbout - Boulon (8x40)
(Ref = 340002)



10

Schroeven - Vis

25mm
(Ref = 310018)

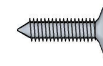

10

35mm
(Ref = 310007)



20

50mm
(Ref = 310013)



16

70mm
(Ref = 310009)



8

100mm
(Ref = 310005)

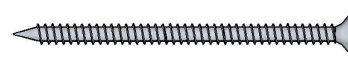

28

Schroef + kapje - Vis + capuchon (100mm)
(Ref = 310005 & 399007)

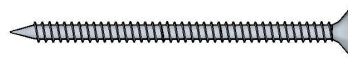

65

HDB/SET11

Voor artikel / Pour article:

4602

4604

4612AC

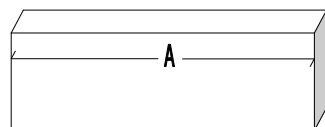

ARTIKEL NR

NR ARTICLE

P2/0195

S/044/060/0070

AANTAL

NOMBRE

3

6

FUNCTIE

FONCTION

hulpdakbalk / poutre de toit d'aide

hulpdakbalk / poutre de toit d'aide



SSL/0230

HSL/0230

7

4

sierlat / latte de finition

sierlat hoek / latte de finition coin

HDB/SET9

Voor artikel / Pour article:

4600AB4030

4600AB4040

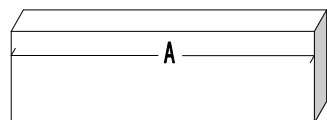

<u>ARTIKEL NR</u>	<u>AANTAL</u>	<u>FUNCTIE</u>
<u>NR ARTICLE</u>	<u>NOMBRE</u>	<u>FONCTION</u>
P2/0195	2	hulpdakbalk / poutre de toit d'aide

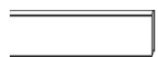

SSL/0230	2	sierlat / latte de finition
----------	---	-----------------------------